

Reimagining SINGAPORE 2030

To achieve happiness, prosperity
and progress for our nation



IPS is grateful to the following organisations for their support of the Institute, Reimagining Singapore 2030 (which includes Quest2030)



OUE

**TAN EAN KIAM
FOUNDATION**

Energy Market Authority
Enterprise Singapore
EY
Institute of Technical Education
Majlis Ugama Islam Singapura
Nanyang Polytechnic

Pontiac Land Group
Republic Polytechnic
Sport Singapore
Temasek International
The Silent Foundation
Urban Redevelopment Authority

QUEST2030

An online experience tool
that is part of

REIMAGINING SINGAPORE 2030

a scenario-planning project of the Institute of Policy Studies, NUS
(October 2020 to October 2022)

QUEST2030 – Logging On

QR Code for QUEST2030

Go to QUEST2030 and Share your journey

- Screenshot your journey
- Use #quest2030sg on Twitter

The IPS Quest2030 comprises

- Gillian Koh
- Christopher Gee
- Chew Han-Ei
- Eddie Choo
- Gabriel Lim

The development specialists behind Quest2030 comprise

- Ori Sasson, Martin Hoel, Jo Hoel, John Sweeney and team at S2T
- Wilson Chew and team at Reassemble



Central question of Reimagining Singapore 2030 and Quest2030:

**“How will we achieve happiness, prosperity and progress
for our nation in 2030 and beyond?”**

Pause, ponder and plan...
the choices and adaptations we need
to be a resilient and cohesive nation
and to create a sustainable and inclusive economy
in an era defined by the COVID-19 pandemic
and shifts in geopolitical and economic power.

QUEST2030 IN A NUTSHELL

This IPS project aims to engage the public in **re-perceiving our future** in year 2030 given the effect of the pandemic, pre-existing trends, and other emerging trends.

How will Singapore respond over the decade, through this period of radical uncertainty? How will this set us up for our long-term future?

Using a free, web-based application, **members of the public are invited to** share their views on key trends and in that way, **craft alternative possible futures** of Singapore.

Leaders of and experts in different fields will then take the public's views and recommend policies, action plans or even pilot studies that will help Singapore achieve “happiness, prosperity and progress” considering the range of ways trends can play out.

QUEST2030 IN A NUTSHELL

This project is funded by IPS and its sponsors.

The objectives of this public engagement around scenarios are:

- To generate discussions about the drivers of change (“driving forces”) that will re-shape Singapore’s future, informed by experts and representatives of key stakeholder groups;
- To contribute to the sense that it is nonetheless possible and important that the Singaporean community takes an active, collaborative, adaptive approach to shaping the country’s future; and
- To redefine the ideas of “resilience”, “social solidarity”, “new opportunities” in the evolving global context that Singapore will find itself in this decade and beyond.

Quest2030 is the tool by which we do this. It is **conceptualised** by IPS researchers, with **content** contributed by experts and leaders across several fields and stakeholder groups, and **designed and programmed** by S2T and Reassemble, led by UX designer Wilson Chew, and a team of specialists in data analysis.

Quest2030 -- Phase 3 of Reimagining Singapore 2030

PHASE ONE: HEARING WIDELY

Open Consultation, YSC2020 and SP2021, selected thought-leaders

PHASE TWO: PICKING WISELY

Workshops and Conference to Identify Driving Forces of Change, Develop Scenarios, and Create the Online Engagement Tool

PHASE THREE: LISTENING DEEPLY

Public Engagement Through Online Engagement Tool, **Quest2030** and Face-to-Face Focus Group Discussions

PHASE FOUR: PLANNING STRATEGICALLY

Development of Recommendations, Action Plans and Pilots

PHASE ONE - HEARING WIDELY

October 2020 to January 2021 (Completed)

Online forums with thinkers and citizens here and abroad at IPS YSC 2020 and SP2021

- Open consultation and divergent thinking on the trends that will shape the world from 2020 to 2030, and beyond.
- IPS Young Singaporeans Conference 2020: Choices, 25-27 November 2020, and online, global engagement at the flagship IPS Singapore Perspectives Conference: Reset, January 2021.
- Key trends and concerns regarding Singapore's future from this phase are brought forward to Phase Two workshops.

PHASE TWO: PICKING WISELY

September to December 2021 (Workshops and Conference completed)

Up to seven workshops and one conference to identify driving forces of change and the creation of the official Reimagining Singapore Scenarios for public engagement; design workshop to create the online engagement tool

- Multi-disciplinary workshops and one conference with Singaporeans thought-leaders, civic activists and leaders of the key domains of the economy and society on the drivers of change to develop one official set of scenarios.
- Design workshop to develop the online engagement tool for Phase Three.

PHASE TWO: PICKING WISELY

Workshops were organised around the following themes
(where the domains covered are stated in bold):

1. Community, Well-Being and the **Soul of the Nation**
2. Identity, Culture and **Diversity**
3. Leadership, Participation and **Governance**
4. Innovation, the Global Economy and **Economic Development**
5. Technology, Environment and **Liveability**
6. Multilateralism, the Evolving Geopolitical Order and **Global Cities**
7. Pandemics and other Non-Traditional Threats to **Human Security**

This phase concluded with a conference that brought together the participants of all seven workshops.

PHASE TWO: PICKING WISELY

Final Critical Uncertainties		
Polarity 1	Critical Uncertainty	Polarity 2
Widening inequality of income and wealth, greater social unrest.	The distributive effect of the economic system	More equitable growth in income and wealth, less social unrest
Feel less agency: We become inclined to passivity and relying on authorities, etc., as the holders of power	Will Singaporeans feel like they have more agency in our collective future?	Feel more agency: We therefore are inclined to actively create change towards our desired futures
Peaceful and cooperative	Will our regional security environment be peaceful or violent?	Wars and conflicts

PHASE THREE: LISTENING DEEPLY

December 2021 to August 2022

Public engagement through the online engagement tool, called **Quest2030**, and focus group discussions on scenarios

- Singaporeans respond to the scenarios through Quest2030. (Target >20 000 participants.) The tool allows Singaporeans to see how trends in one area affect those in other areas; choices in one area could affect outcomes in other areas. Users can interact with each other. These are what lead to alternative futures in the tool, and provoke thought about our common future in 2030 and beyond.
- Focus group discussions with segments that are less internet-savvy or in special domains (senior citizens, vulnerable/special needs populations & carers, artists and sporting community, innovators and inventors, new citizens).
- Report on key outcomes are brought to Phase Four.

QUEST2030 – INSIGHT GENERATION

An engagement tool for Singaporeans to share their views on the future via mobile phones, tablet and laptop browsers.

- Quest2030 will present users with a series of **questions** about the future, and users will be faced with **choices on key issue areas**. They can **interact, add to the elements in the tool, and view how others approach the future**.
- Based on users' choices and further input, Quest2030 will gradually aggregate **anonymised data** of how Singaporeans approach the future.
- This will surface the **diversity** and **commonalities** of the views of the public as they respond to the scenarios, and provide archetypes of Singaporeans in their approach to the future. This is captured by the alternative scenarios of Singapore in 2030.

QUEST2030 – Basic Principles

Quest2030 will not predict the future. Rather, it allows users to **explore possible futures with each other.**

By providing a **set of stimuli** (ie. the trends or stimuli from the workshops conducted in Phase 2 of the project), we invite users to share their views on how key trends may play out from now till 2030 and therefore stimulate fresh thinking about the future through:

- The Intersection of **Different Perspectives**
- A Dialogue of **Knowledge and Decisions**
- A Series of Quests, making a **Journey of Choices**

QUEST2030 – Three Levels of Participation

There are three levels of participation.

Level 1 (Basic Level): 3 questions, resulting in a scenario

Level 2 (Explorer Level): 11 more questions, resulting a more nuanced scenario

Level 3 (Creator Level): create artefacts, write headlines that subsequent participants can view

With the completion at each level, achievement badges can be collected. Artefacts and pictures of iconic locations in Singapore transformed in those scenarios, can be “unlocked” with the collection of these achievement badges.

QUEST2030 – The Start

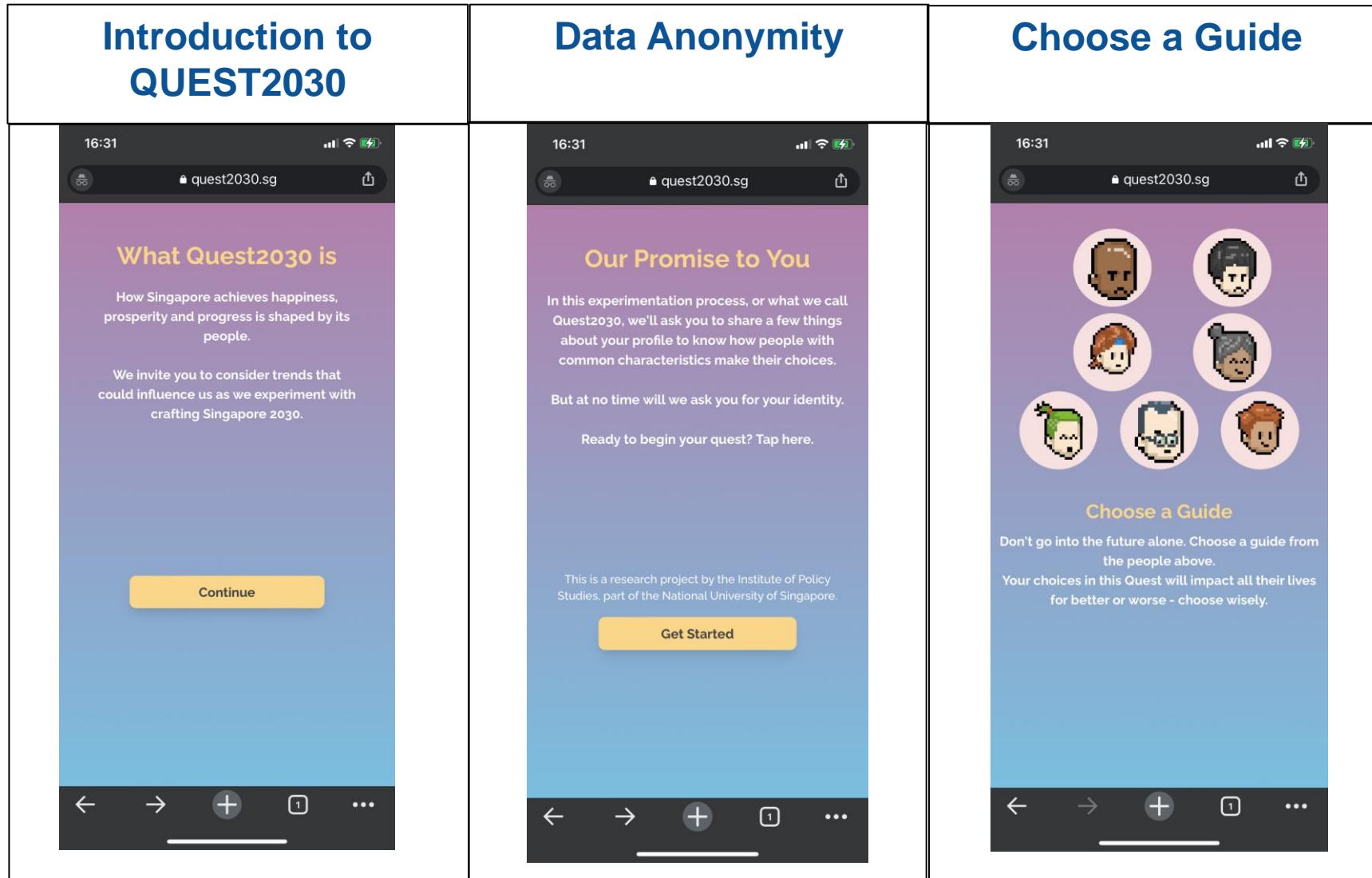

QUEST2030 – The First Level (Quester)

Complete the First Three Questions

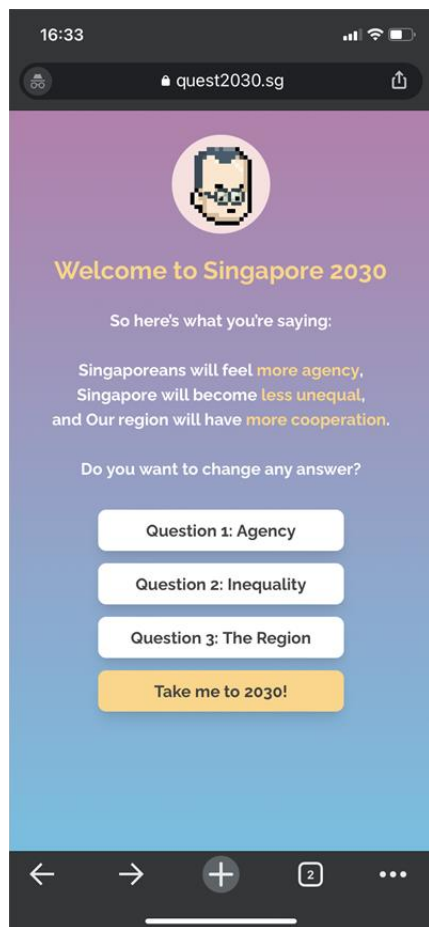

Your Version of Singapore in 2030

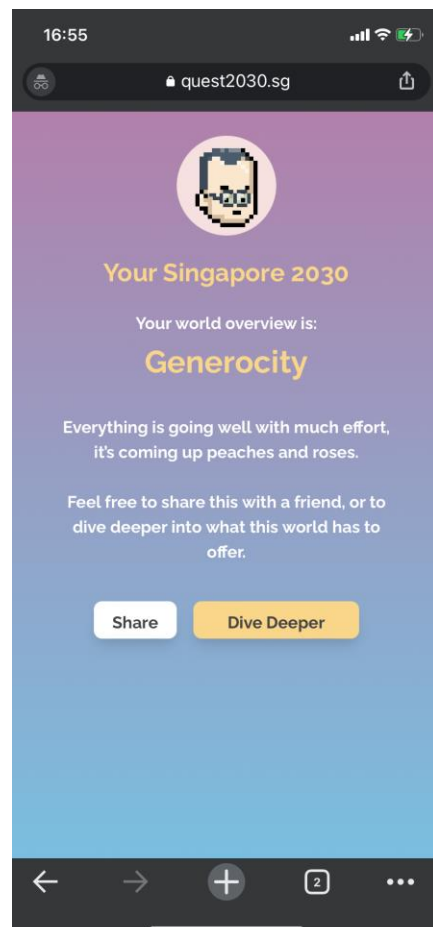

Where You Stand

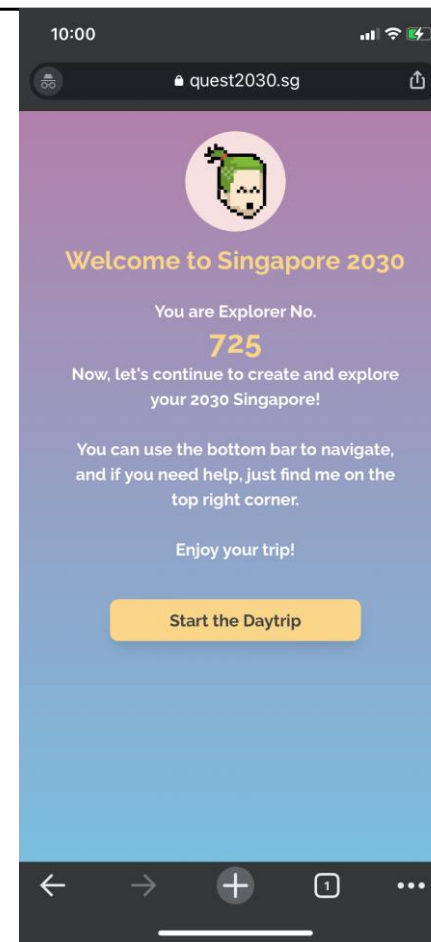

The Attributes of That Singapore

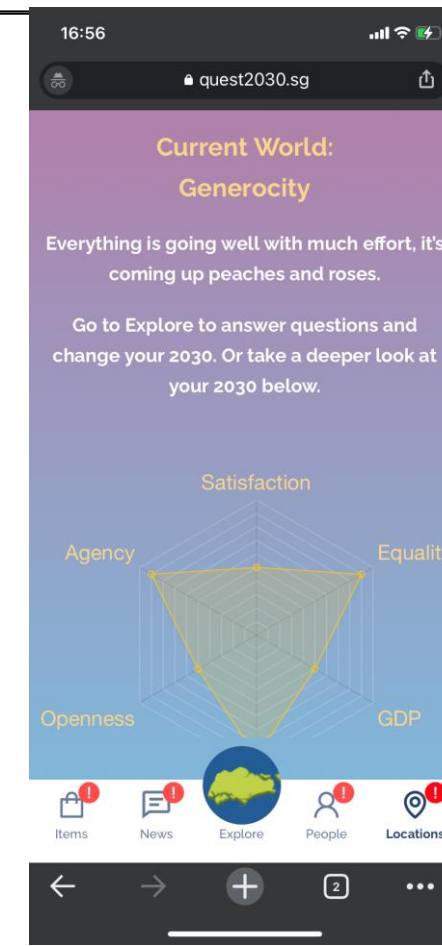

QUEST2030 – The Second Level (Explorer)

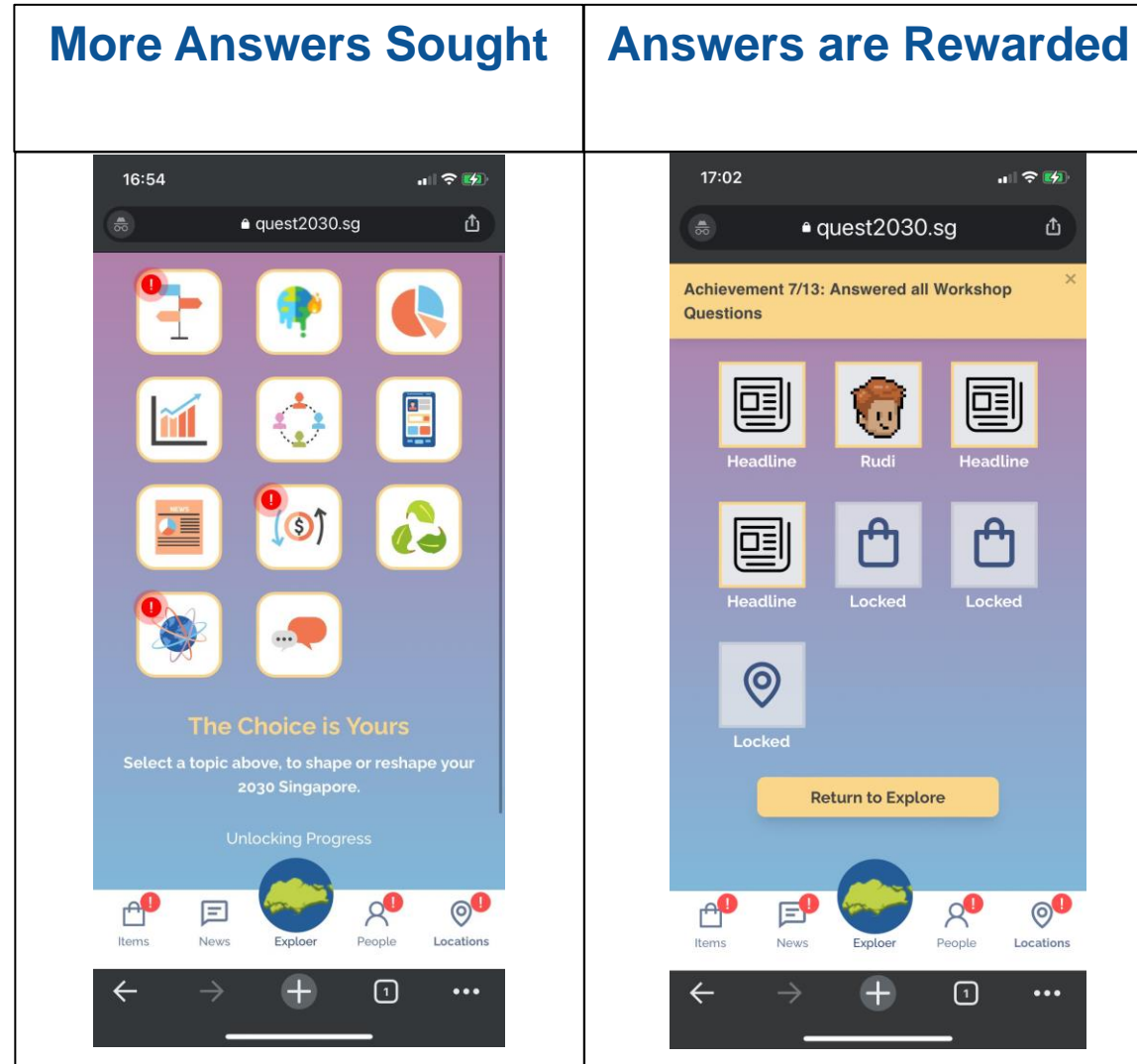

QUEST2030 – The Second Level

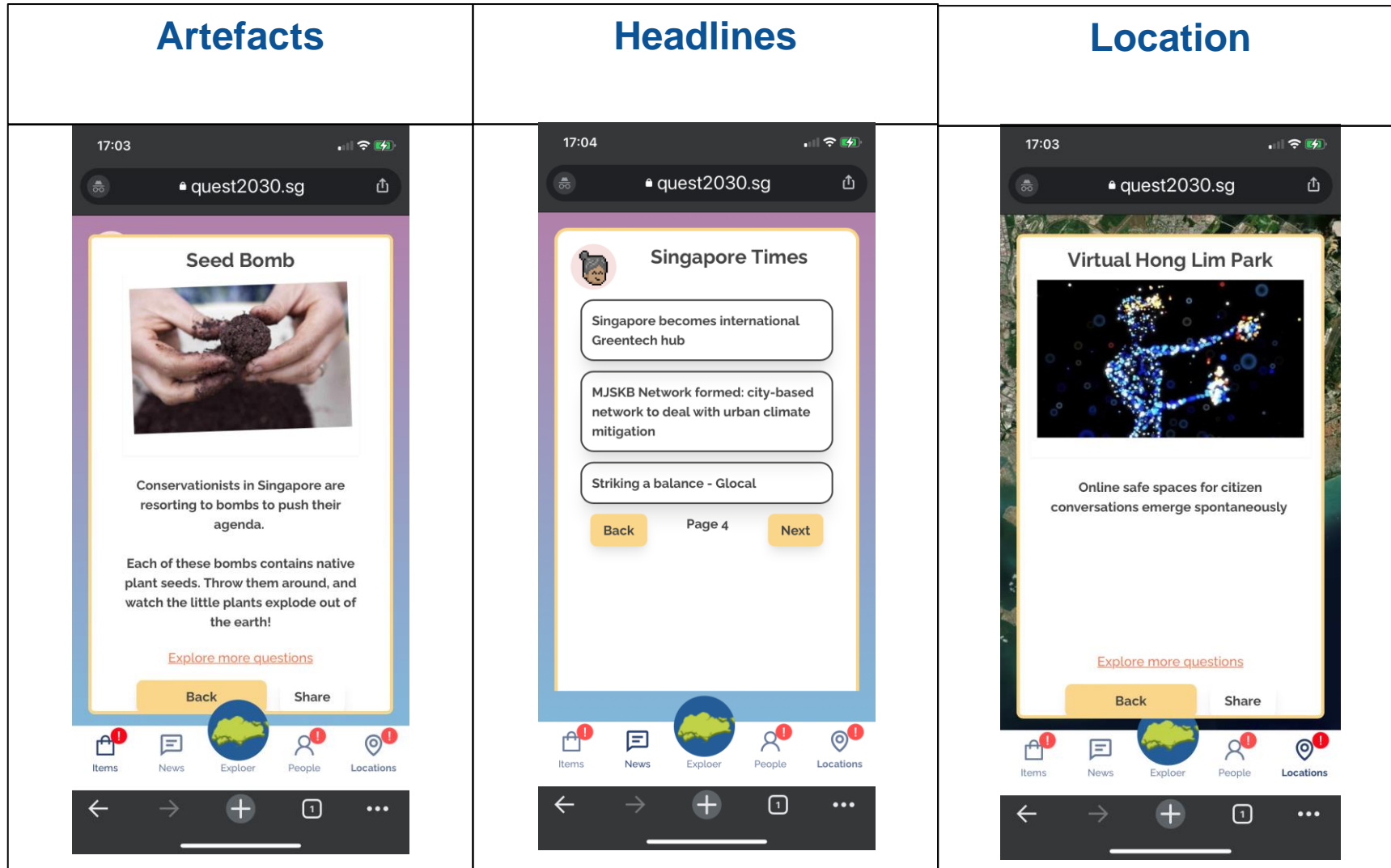

QUEST2030 – Share your Singapore2030

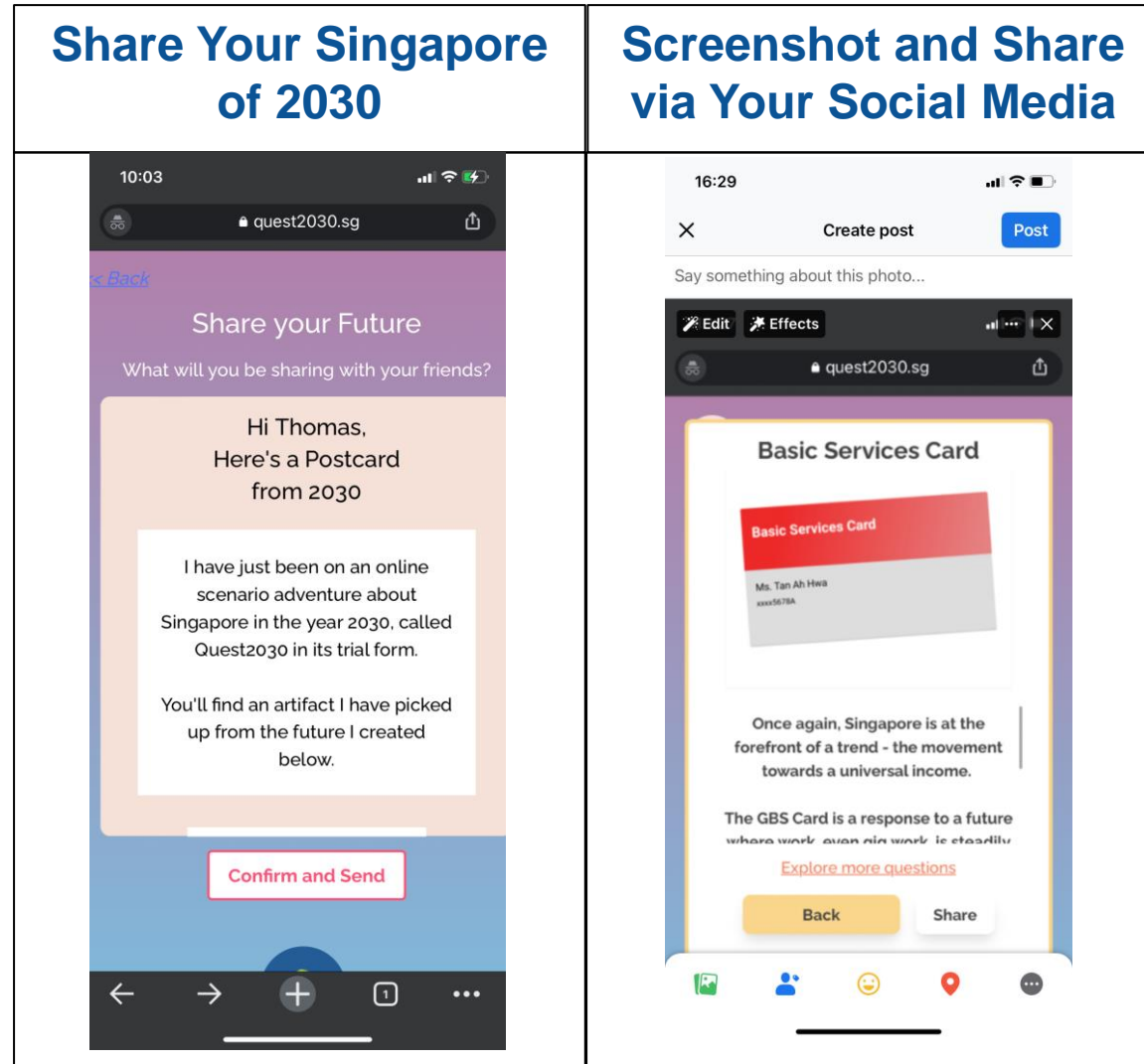

Quest2030 – The Third Level (Creator)

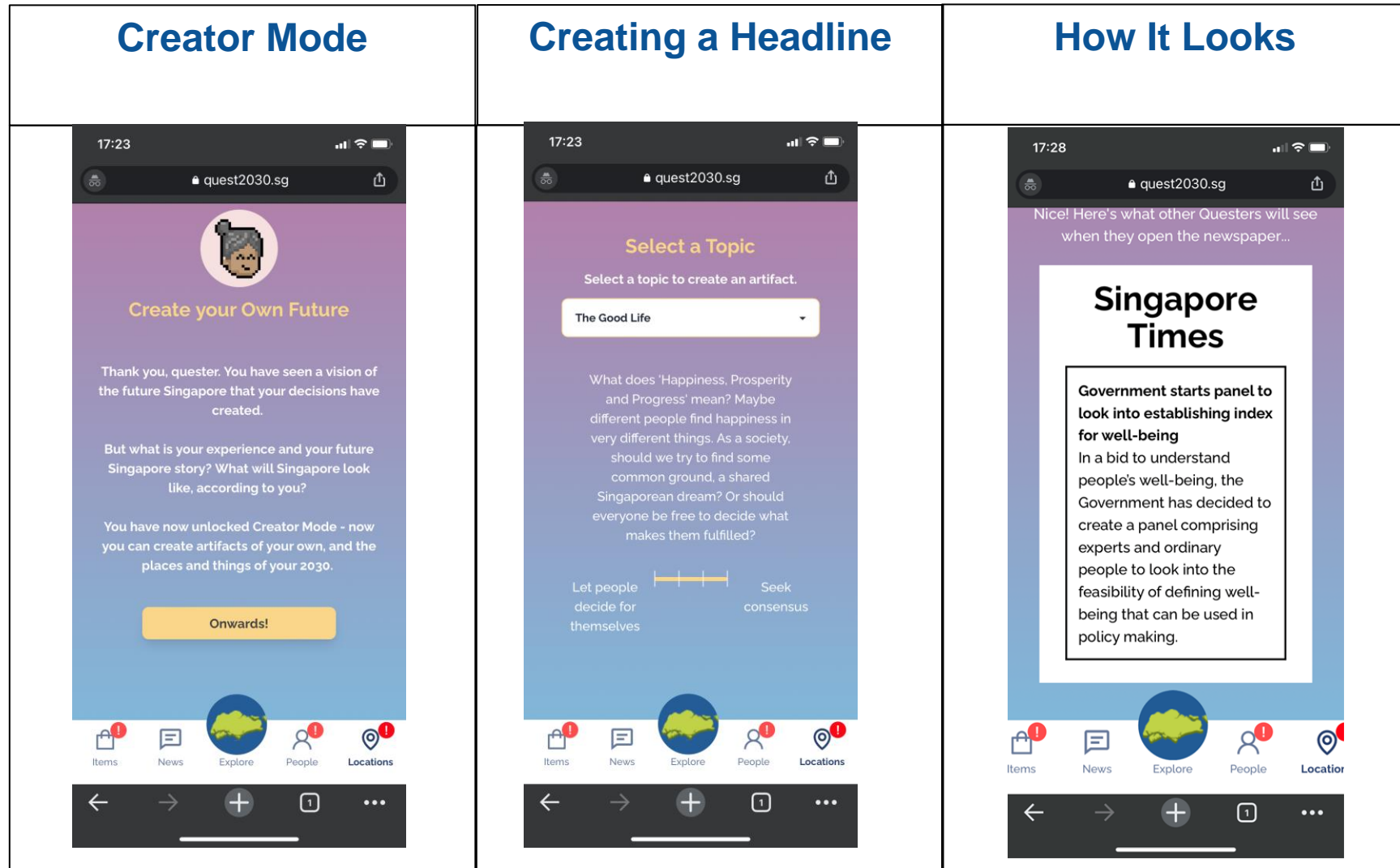

PHASE FOUR: PLANNING STRATEGICALLY

September 2022 to October 2022

Strategy workshops

The participants of the Phase Two workshops recommend strategies, action plans and pilots based on the analysis of the public's response to the scenarios.

IPS will track immediate and medium-term propagation of strategies, action plans and pilots.

Reporting on the project – October 2022 onwards

The End

OUTPUT FROM WORKSHOPS – CONTENT FOR QUEST2030

Workshop 1: Identity, Culture and Diversity		
Polarity 1	Critical Uncertainty	Polarity 2
Maintaining status quo: Acceptance or acquiescence of the status quo: unwillingness to intervene, apathy or tolerance	Build ethical ally-ship of diversity and inclusion	Speaking up: Understanding the difference between acceptable and unacceptable behaviour; taking action and intervening, even if it sometimes backfires; ethical behaviour
Freedom of information and discussion, leads to more dissent and non-moderated opinions	Transparency and openness of data and discussions on social topics	Mobilisation of information and data to create and steer discussions, leads to more curated discussions

Workshop 2: Environment, Technology and Liveability		
Polarity 1	Critical Uncertainty	Polarity 2
Increased interdependence and collaboration supporting efforts in reducing carbon emissions and moving towards energy transition	Regional responses to climate crisis	Lack of cohesive response by ASEAN; Singapore forced to go alone and rely on its own technological responses
Orientating the economy for growth, and prioritising resource generation for climate change response and redistribution	Economic development plans and business models	Orientating and adapting the economy for sustainability; prioritising the environment, liveability, and equity by changing economic structures

OUTPUT FROM WORKSHOPS – CONTENT FOR QUEST2030

Workshop 3: Multilateralism, the Evolving Geopolitical Order, and Global Cities		
Polarity 1	Critical Uncertainty	Polarity 2
Inward focus/ struggle to accept flows of people/ ideas, more focused on Singapore as a nation, less economically dependent on forces outside the country than is currently the case	Citizen psyche in relation to global connection and interdependence	Greater connection and openness where citizens embrace Singapore's identity as a global city, they want to be viewed as global cities, and are therefore more accepting of inflow of people and ideas.
Weak institutions, competitive dynamics	Climate change cooperation	Successful multilateral cooperation and city-level networks

Workshop 4: Pandemics and Other Non-Traditional Threats to Human Security		
Polarity 1	Critical Uncertainty	Polarity 2
Technology and 3P (public, private, people) mitigation efforts are aligned in action and shield Singapore from the negative impact of climate change	Will climate change affect Singapore's liveability?	Technology and 3P efforts are not aligned in action and underperform; parts of Singapore become unliveable (e.g., submerged underwater)
Less trust in government and experts, increased trust in non-traditional media and misinformation	Will there be a crisis of legitimacy going forward?	More trust in government and experts amidst misinformation

OUTPUT FROM WORKSHOPS – CONTENT FOR QUEST2030

Workshop 5: Leadership, Participation, and Governance		
Polarity 1	Critical Uncertainty	Polarity 2
Declining trust	Political — trust in the system of governance and of governing elites	Growing trust
Overbidding — chasing virality and clout for entertainment leads to ratcheting extremism	As social media becomes part of public discourse, how will “clout-chasing” factor in policy?	Boundaries hold — views are expressed without being extreme

Workshop 6: Innovation, the Global Economy and Economic Development		
Polarity 1	Critical Uncertainty	Polarity 2
The magnetism is reinforced, with more openness	Future of Singapore’s Hub of Hubs	Lose our special magnetism, and no longer have openness
More equitable growth in income and wealth, less social unrest	The distributive effect of the economic system	Widening inequality of income and wealth, greater social unrest

OUTPUT FROM WORKSHOPS – CONTENT FOR QUEST2030

Workshop 7: Community Well-Being and the Soul of the Nation		
Polarity 1	Critical Uncertainty	Polarity 2
Convergence on broadly accepted ideals with space for difference and change	Will Singaporeans increasingly differ in what they consider to be a desirable society?	“Civil Cold War”: To each their own; contested and imposed models of the good life; this could either generate dynamism or impasse
Process-oriented and holistic	Orientation towards creating the future	Outcome-oriented and focused on specific and specialised approach